



# NORTH AMERICA PRODUCT CATALOG

## BLOOD COLLECTION DEVICES



**[sol-m.com](https://sol-m.com) | [info@sol-m.com](mailto:info@sol-m.com)**

NACA-M TP-276-1121

©2022 Sol-Millennium Medical Inc. All rights reserved.

**Sol-Millennium** is a vertically integrated global medical supply company with locations across the globe. We are one of the world's largest manufacturers of needles and syringes and have a comprehensive line of medical supplies.

Our innovative technology reduces needlestick injuries, saves on medication expenses and enhances both clinician and patient experience. Our international sales team is dedicated to delivering knowledge and outstanding customer service. Our goal is to work together as partners in the healthcare industry, focusing on a healthier tomorrow.



Global HQ



Research & Development



Sales, Marketing & Distribution



Manufacturing

# ► Table of Contents



**Sol-Guard® Safety Pull-Button  
Blood Collection Sets**

**5-6**



**Sol-Care® Safety Blood Collection  
Tube Holder Set**

**7-8**



**Sol-M® Multi-Sample Needle**

**9**



**Sol-Care® Safety Multi-Sample Needle**

**10**



**Sol-Care® Safety Blood Collection Needles**

**11-12**



**Sol-Care® Heel & Safety Lancet**

**13**



**Sol-M® Blood Lancets & Lancing Device**

**14**



**Accessories - Tube Holders, Luer  
Adapter, Tourniquet**

**15-16**



**Sol-Care® Alcohol Swabs**

**17**



**Quick Ordering Reference**

**18-19**

# ► ● Blood Collection

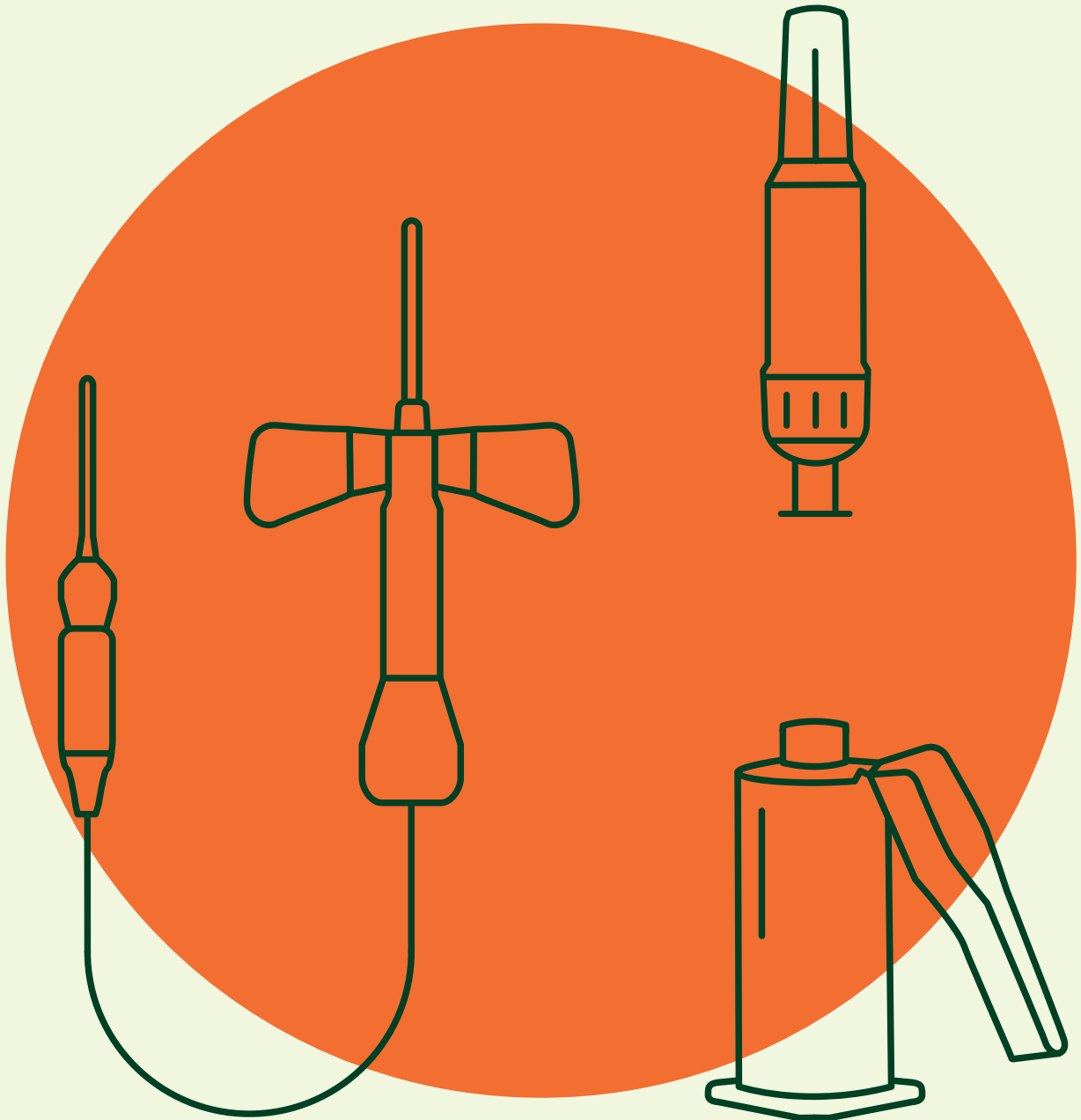

## Safety needles

create a

**4-fold  
reduction**

in needlestick  
injuries



Needlestick injury is a major risk for healthcare professionals utilizing needles and sharps, which puts them at risk for blood-borne pathogens. **Safety blood collection devices and other safety engineered devices have been shown to create a 4-fold reduction in these types of needlestick injuries.<sup>1</sup>**

Sol-Millennium's® safety blood collection devices help to minimize the risk of accidental needlestick injuries. We offer a full array of products to address the various needs in the marketplace.

1. Tosini, William, et al. "Needlestick Injury Rates According to Different Types of Safety-Engineered Devices: Results of a French Multicenter Study." *Infection Control and Hospital Epidemiology*, vol. 31, no. 4, Apr. 2010, doi:10.1086/651301 2. International Safety Center U.S. EPINet Sharps Injury and Blood and Body Fluid Exposure Surveillance Research Group. Sharps Injury Data Report for 2015. Report available at <https://internationalsafetycenter.org/exposure-reports>



# Sol - Guard™



## ● Safety Pull-Button Blood Collection Sets

Sol-Guard™ Safety Pull-Button Blood Collection Sets promote single-handed in-vein safety activation to instantly retract the needle after use, helping prevent needlestick injury and bloodborne pathogen exposure.

With ease, safety and comfort in mind, this device features an exclusive version of the “Butterfly Needle”, designed with a sliding button that using pull force, activates in-vein needle retraction after use.

### Features:

- Low angled tri-bevel tip designed to improve penetration, while minimizing patient discomfort
- Thin-wall needle for fast flow rate and to reduce the risk of blood hemolysis
- Tactile non-slip grip to help engage the safety feature
- 30% wider wings for improved handling during insertion and removal
- Large oversized arrow to easily identify the activation pull button
- Flashback for instant and clear confirmation of proper needle placement
- Spring mechanism for split second in-vein needle retraction

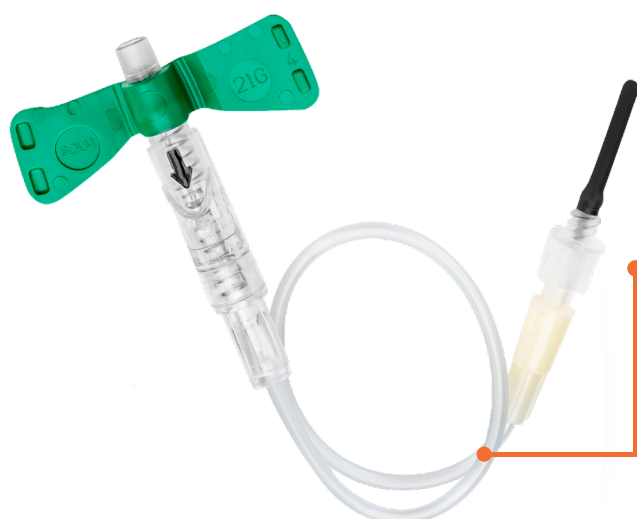

**Sol-Guard™ Safety  
Pull-Button Blood  
Collection Set**



**Sol-Guard™ Safety  
Pull-Button Blood Collection Set  
with Pre-attached Holder**

Blood  
flashback and  
flow are easy  
to visualize

Available  
with or without  
pre-attached  
holder

# Providing a **Safe, Easy & Comfortable** Blood Collection Experience

## 88%

Reduction in needlestick injuries with in-vein needle retraction safety activation<sup>1</sup>

## 2,000,000

Estimated number of needlestick and other sharps related injuries annually<sup>2</sup>

3

## 41%

of phlebotomist incur injuries from blood-draw procedures annually<sup>3</sup>



BLOOD COLLECTION



Before



After

4> internal data  
43 vs 33 wing size

## Sol-Guard® Safety Pull-Button Blood Collection Sets

Reference number		Needle outer diameter		Needle length		Tubing length	
without pre-attached holder	with pre-attached holder	Gauge	Millimeters	Inches	Millimeter	Inches	Millimeter
PBH2107	PBLA2107	21G	0.8 mm	3/4"	19 mm	7"	178 mm
PBH2307	PBLA2307	23G	0.6 mm	3/4"	19 mm	7"	178 mm
PBH2507	PBLA2507	25G	0.5 mm	3/4"	19 mm	7"	178 mm
PBH2112	PBLA2112	21G	0.8 mm	3/4"	19 mm	12"	305 mm
PBH2312	PBLA2312	23G	0.6 mm	3/4"	19 mm	12"	305 mm
PBH2512	PBLA2512	25G	0.5 mm	3/4"	19 mm	12"	305 mm
N/A	SPB001*	21G	0.8 mm	3/4"	19 mm	12"	305 mm
N/A	SPB002*	23G	0.6 mm	3/4"	19 mm	12"	305 mm
N/A	SPB003*	25G	0.5 mm	3/4"	19 mm	12"	305 mm

Sales Unit    With pre-attached holder: 25 pcs/Box; 200 pcs/Case  
Without pre-attached holder: 50 pcs/Box; 200 pcs/Case

\*Reference number for SA market





# Sol-Care™



## ● Safety Blood Collection Tube Holder Set

The Sol-Care™ Safety Blood Collection Tube Holder Set is an innovative, exclusive blood collection safety accessory. The unique retraction mechanism is built into the special tube. After all specimens are drawn, the tube is pushed into the needle/hub assembly and withdraws the used needle, protecting the healthcare worker from any chance of accidental needlestick.

This new safety device requires no additional movements or changes in technique. The activation is accomplished using the same forward pressure as is customary when using all other blood collection tubes.

### Features:

- Totally passive as to hand repositioning; dominant hand continue to remain on last tube and behind the proximal end of tube holder
- Hands remain behind needle during the point of greatest potential hazard
- Safety mechanism is integral part of device and doesn't block sight of needle tip
- Complies with OSHA regulations to prevent cross-contamination
- Once captured, used blood collection needle is totally encapsulated within the yellow safety tube for disposal into sharps container

Compatible with  
standard multi-sample  
needles and blood  
collection tubes



**Blood Collection  
Tube Holder**



**Vacuum Activation  
Blood Collection Tube**

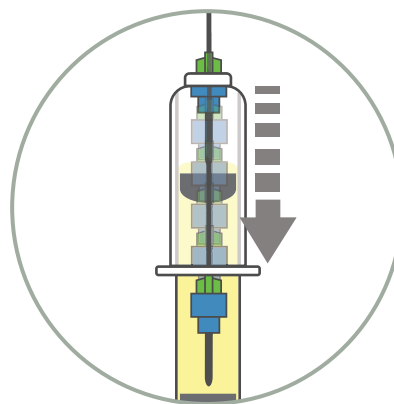

Pioneering retractable  
technology that withdraws  
needle into the tube using  
vacuum pressure



**Activated Tube**



## Instructions for Use:

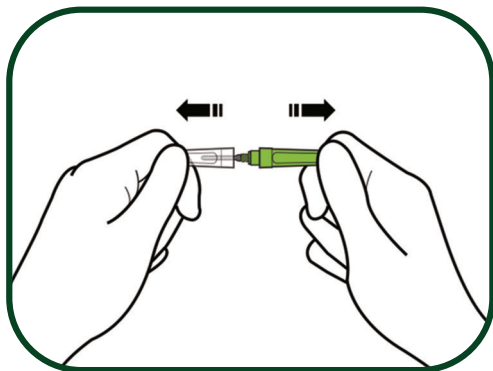

**Step 1:** Remove clear cap.

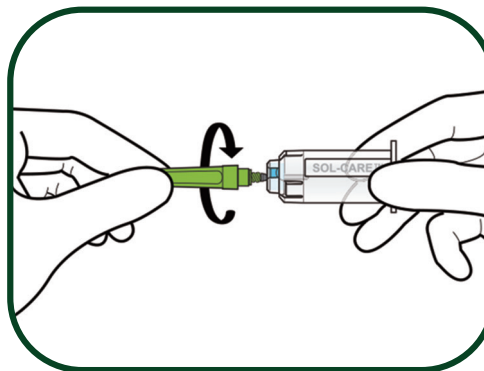

**Step 2:** Twist needle into tube holder.

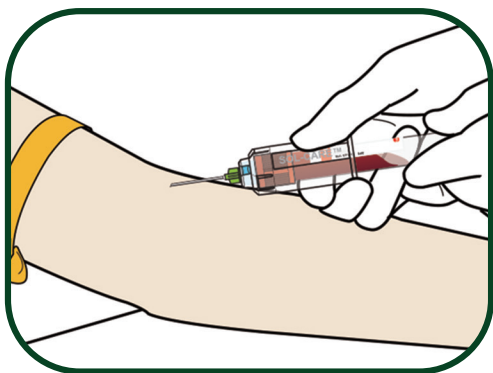

**Step 3:** Remove color-coded cap and insert the needle at a 30 degree angle, advance blood collection tube in the normal manner.

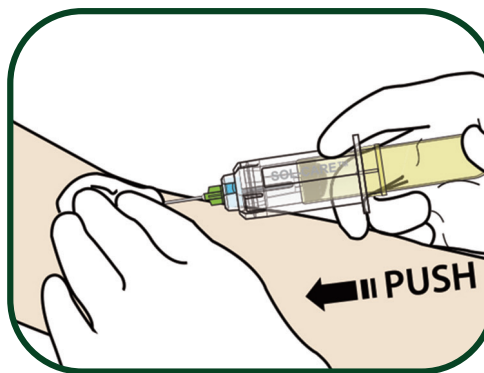

**Step 4:** After removing the final blood collection tube, advance the Vacuum Activation Blood Collection Tube and push forward using the same motion as with any blood collection tube.

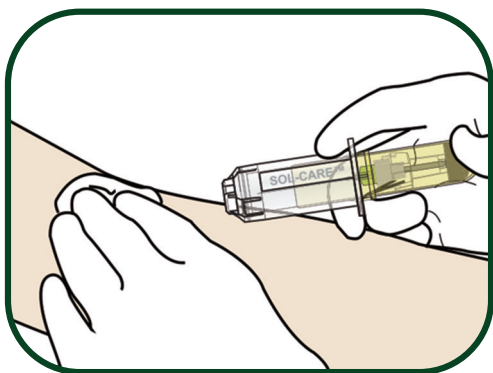

**Step 5:** Press to activate the vacuum retraction of the needle. The needle will withdraw into the tube holder. Apply pressure to the insertion site as per the normal procedure.

### Sol-Care™ Safety Blood Collection Tube Holder Set

Reference Number	Box Qty	Case Qty
7001BCD	50	400



BLOOD COLLECTION



# Sol-M™

## ● Multi-Sample Needle

- Black dot on multi-sample needle hub ensures bevel up orientation
- Low-angle bevel design allows easy penetration
- Color-coded caps and hubs allow easy identification of needle gauge size
- Compatible with all standard holders



### Sol-M™ Multi-Sample Needle

Reference Number	Gauge	Needle Length	Box Qty	Case Qty
110201020008	18G	1"	100	1,000
110201020009	18G	1 1/2"	100	1,000
110201020006	20G	1"	100	1,000
110201020007	20G	1 1/2"	100	1,000
110201020004	21G	1"	100	1,000
110201020005	21G	1 1/2"	100	1,000
110201020002	22G	1"	100	1,000
110201020003	22G	1 1/2"	100	1,000



## ● Safety Multi-Sample Needle

The Sol-Care™ Safety Multi-Sample Blood Collection Needle is designed with a safety shield that completely covers and locks over the needle after use to protect against needlestick injuries.

### Features:

- Safety shield aligns with a bevel up needle orientation, allowing for low-angle penetration
- Pivoting safety shield with audible click that indicates it is locked in place
- Safety mechanism is designed for one-handed activation
- Safety shield is color coded to reduce potential errors



### Sol-Care™ Safety Multi-Sample Needle

Reference Number	Gauge	Needle Length	Box Qty	Case Qty
SMSN21125	21G	1 1/4"	48	480
SMSN22125	22G	1 1/4"	48	480

### Sol-Care™ Safety Multi-Sample Needle with Pre-attached Holder

Reference Number	Gauge	Needle Length	Box Qty	Case Qty
SMSNH21125	21G	1 1/4"	50	400
SMSNH22125	22G	1 1/4"	50	400



# Sol-Care™



## ● Safety Winged Blood Collection Needle

The Sol-Care™ Safety Blood Collection Needle is a safety-engineered device with a sliding safety shield that clicks when activated, telling you the needle is safely locked.

### Features:

- Transparent design that allows visualization of the blood flashback and flow
- Single-handed activation option that provides more flexibility to care for the patient and venepuncture site
- Sliding safety shield pushes over the needle and locks with an audible

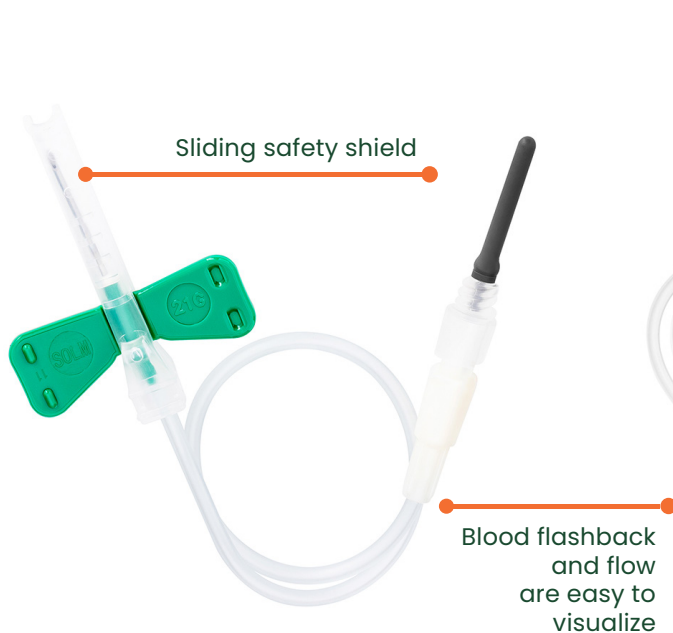

**Sol-Care™ Safety  
Blood Collection Needle  
with Luer Adapter**

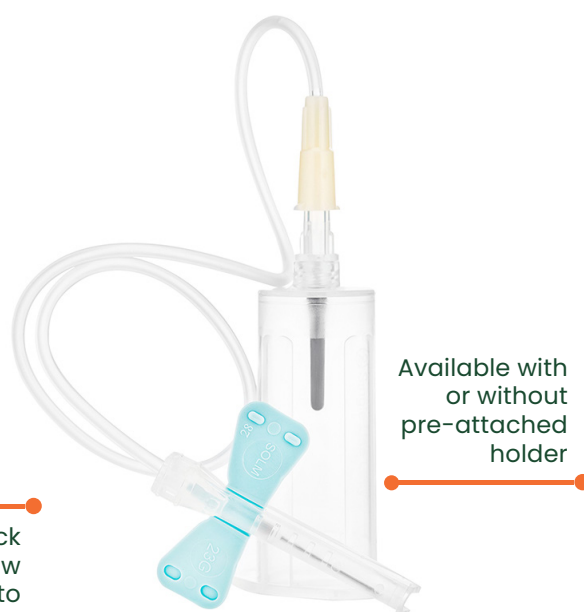

**Sol-Care™ Safety  
Blood Collection Needle  
with Pre-attached Holder**

## Sol-Care™ Safety Winged Blood Collection Needle with Luer Adapter

Reference Number	Gauge	Needle Length	Tubing Length	Box Qty	Case Qty
110201030030	21G	3/4"	7"	50	200
110201030031	21G	3/4"	12 "	50	200
110201030032	23G	3/4"	7"	50	200
110201030033	23G	3/4"	12 "	50	200
110201030034	25G	3/4"	7"	50	200
110201030035	25G	3/4"	12 "	50	200



BLOOD COLLECTION

## Sol-Care™ Safety Winged Blood Collection Needle with Pre-attached Holder

Reference Number	Gauge	Needle Length	Tubing Length	Box Qty	Case Qty
110201030004	21G	3/4"	7"	25	200
110201030002	21G	3/4"	12 "	25	200
110201030008	23G	3/4"	7"	25	200
110201030006	23G	3/4"	12 "	25	200
110201030012	25G	3/4"	7"	25	200
110201030010	25G	3/4"	12 "	25	200



# Sol-Care™

## ● Heel and Safety Lancets

Sol-Millennium's® Sol-Care Safety Lancets are designed for virtually painless testing.

### Features:

- Passive active, spring action technology minimizes misfiring and gently controls penetration depth
- Needle retracts automatically and locks out for safety, protecting against accidental cuts and minimizing the chance of cross-contamination



### Sol-Care™ Safety Lancets

Ref. Number	Description	Penetration Depth(mm)	Gauge	Box	Case
SLA001	Sol-Care Safety Lancet	1.6mm	30G	100 pcs	1,000 pcs
SLA004	Sol-Care Safety Lancet	1.8mm	28G	100 pcs	1,000 pcs
SLA005	Sol-Care Safety Lancet	1.8mm	23G	100 pcs	1,000 pcs
SLA008	Sol-Care Safety Lancet	1.8mm	21G	100 pcs	1,000 pcs

## ● Blood Lancets & Lancing Device

Sol-Millennium's® Sol-M Blood Lancet and Lancing Device are used for capillary blood sampling required in daily diabetes management programs. The lancing device offers 6 settings for depth puncture. Red visual indicator confirms when lancing device is ready for use.

### Features:

- Tri-bevel cut cannula generates proper blood sample size with less pain
- Needle is equipped with a protective cap for increased safety and easier placement
- Lancing device is equipped with triple-tunnel design to reduce vibration of spring ensuring accurate depth and less bruising

### Sol-M™ Blood Lancet

Ref. Number	Description	Gauge	Box	Case
LAN001	Sol-M Blood Lancet	30G	100 pcs	5,000 pcs
LAN002	Sol-M Blood Lancet	28G	100 pcs	5,000 pcs
LAN003	Sol-M Blood Lancet	33G	100 pcs	5,000 pcs

### Sol-M™ Lancing Device

Ref. Number	Description	Box	Case
LAD001	Sol-M Lancing Device	1	200





**Sol - M™****● Blood Collection Tube Holder**

For blood specimen collection and compatible with standard multi-sample needles.

**Sol - M™****● Blood Culture Holder**

For blood culture collection and fits all standard evacuated blood culture bottles. Threads compatible with standard blood collection needles.

**Sol - M™****● Tube Holder with Luer Lock Adapter**

For collecting specimens from IV lines or for urine specimens. Standard female Luer fitting. Compatible with IV sets, ports, and tubing according to ANSI standards.

**Sol - M™****● Blood Transfer Holder**

For the transfer of blood from syringes to vacuum blood specimen tubes. Female Luer slip or Luer Lock compatible.

**Tube Holders**

Reference Number	Description	Box Qty	Case Qty
110201050001	Sol-M Blood Collection Tube Holder	250	1,000
110201050002	Sol-M Blood Culture Holder	40	320
110201050003	Sol-M Tube Holder with Luer Lock Adapter	50	800
BCTH002	Sol-M Blood Transfer Holder	50	800

## Sol - M™

### ● Luer Adapter 20G

The Sol-M Luer Adapter is designed to work in a variety of functions by securely connecting to female Luer connections.

#### Features:

- An ideal accessory to use with blood collection sets that feature a holder for evacuated tubes
- Blue cap to differentiate from other blood collection devices
- Designed to ensure secure connections and fitted with rubber sleeve to ensure no blood spills or exposure



## Sol - M™

### ● Latex-Free Tourniquet

Pre cut, latex free elastic tourniquet strips are packaged in an easy dispensing box that is convenient to use and store.

#### Features:

- Strong, durable, and elastic
- Textured surface
- Space saving, convenient packaging
- Not made with natural rubber latex



#### Other Accessories

Reference Number	Description	Box Qty	Case Qty
LA21920	Sol-M Luer Adapter 20G	100	1,000
TNQ002	Sol-M Latex-Free Tourniquet 1" x 18"	25	2,500





## ● Alcohol Swabs

70% isopropyl alcohol to clean and prepare the skin. Individually wrapped in 4-layer wrappers for an air-tight seal that prevents leakage and drying.

### Features:

- 70% isopropyl alcohol
- Individually wrapped
- Durable wrapper

### Alcohol Swabs

Ref. Number	Description	Size	Box	Case
SIA1001	Sterile Alcohol Swabs – 30mm x 30mm	Medium	100 pcs	10,000 pcs
SIA1002	Sterile Alcohol Swabs – 85mm x 45mm	Large	100 pcs	1,000 pcs
SIA2001	Non-sterile Alcohol Swabs – 30mm x 30mm	Medium	100 pcs	10,000 pcs
SIA2002	Non-sterile Alcohol Swabs – 85mm x 45mm	Large	100 pcs	1,000 pcs



**Individually wrapped  
in multiple sizes.**





# Blood Collection

## Quick Order Guide



BLOOD COLLECTION

### Sol-M™ Multi-Sample Needle

Reference Number	Gauge	Needle Length	Box Qty	Case Qty
110201020008	18G	1"	100	1,000
110201020009	18G	1 1/2"	100	1,000
110201020006	20G	1"	100	1,000
110201020007	20G	1 1/2"	100	1,000
110201020004	21G	1"	100	1,000
110201020005	21G	1 1/2"	100	1,000
110201020002	22G	1"	100	1,000
110201020003	22G	1 1/2"	100	1,000

### Sol-Care™ Safety Multi-Sample Needle

Reference Number	Gauge	Needle Length	Box Qty	Case Qty
SMSN21125	21G	1 1/4"	48	480
SMSN22125	22G	1 1/4"	48	480

### Sol-Care™ Safety Multi-Sample Needle with Pre-attached Holder

Reference Number	Gauge	Needle Length	Box Qty	Case Qty
SMSNH21125	21G	1 1/4"	50	400
SMSNH22125	22G	1 1/4"	50	400

**Sol-Care™ Safety Winged Blood Collection Needle with Luer Adapter**

Reference Number	Gauge	Needle Length	Tubing Length	Box Qty	Case Qty
110201030030	21G	3/4"	7"	50	200
110201030031	21G	3/4"	12 "	50	200
110201030032	23G	3/4"	7"	50	200
110201030033	23G	3/4"	12 "	50	200
110201030034	25G	3/4"	7"	50	200
110201030035	25G	3/4"	12 "	50	200

**Sol-Care™ Safety Winged Blood Collection Needle with Pre-attached Holder**

Reference Number	Gauge	Needle Length	Tubing Length	Box Qty	Case Qty
110201030004	21G	3/4"	7"	25	200
110201030002	21G	3/4"	12 "	25	200
110201030008	23G	3/4"	7"	25	200
110201030006	23G	3/4"	12 "	25	200
110201030012	25G	3/4"	7"	25	200
110201030010	25G	3/4"	12 "	25	200

**Sol-Care™ Safety Blood Collection Tube Holder Set**

Reference Number	Box Qty	Case Qty
7001BCD	50	400

**Sol-Care™ Safety Lancets**

Ref. Number	Description	Penetration Depth(mm)	Gauge	Box	Case
SLA001	Sol-Care Safety Lancet	1.6mm	30G	100 pcs	1,000 pcs
SLA004	Sol-Care Safety Lancet	1.8mm	28G	100 pcs	1,000 pcs
SLA005	Sol-Care Safety Lancet	1.8mm	23G	100 pcs	1,000 pcs
SLA008	Sol-Care Safety Lancet	1.8mm	21G	100 pcs	1,000 pcs



### Sol-M™ Blood Lancets

Ref. Number	Description	Gauge	Box	Case
LAN001	Sol-M Blood Lancet	30G	100 pcs	5,000 pcs
LAN002	Sol-M Blood Lancet	28G	100 pcs	5,000 pcs
LAN003	Sol-M Blood Lancet	33G	100 pcs	5,000 pcs

### Sol-M™ Blood Lancing Device

Ref. Number	Description	Box	Case
LAD001	Sol-M Lancing Device	1	200

### Accessories

Ref. Number	Description	Box Qty	Case Qty
LA21920	Sol-M Luer Adapter 20G	100	1,000
TNQ002	Sol-M Latex-Free Tourniquet 1" x 18"	25	2,500
110201050001	Sol-M Blood Collection Tube Holder	250	1,000
110201050002	Sol-M Blood Culture Holder	40	320
110201050003	Sol-M Tube Holder with Luer Lock Adapter	200	800
BCTH002	Sol-M Blood Transfer Holder	200	800

### Alcohol Swabs

Ref. Number	Description	Size	Box	Case
SIA1001	Sterile Alcohol Swabs – 30mm x 30mm	Medium	100 pcs	10,000 pcs
SIA1002	Sterile Alcohol Swabs – 85mm x 45mm	Large	100 pcs	1,000 pcs
SIA2001	Non-sterile Alcohol Swabs – 30mm x 30mm	Medium	100 pcs	10,000 pcs
SIA2002	Non-sterile Alcohol Swabs – 85mm x 45mm	Large	100 pcs	1,000 pcs



**[solm.com](https://solm.com) | [info@solm.com](mailto:info@solm.com)**

